

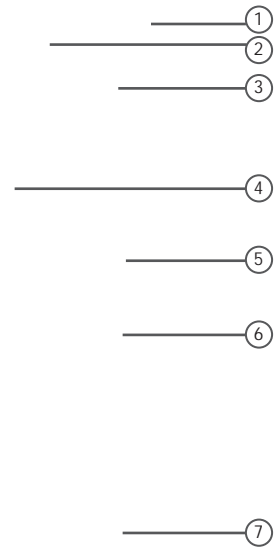

LS6000 Freestanding Canopy Leg Kit

Free Standing Canopy Leg Kit
Shown with canvas and frame which are sold separately.



PARTS LIST

REF.	PART NO.	PART NAME	QTY.	RETAIL PRICE (EACH)
1	SSHC	Hose ClampsStainless Steel	8	\$4.00
2	DCS	Diagonal Canopy Support	4	\$25.00
3	CANFS120	Freestanding Canopy Leg Assembly	3	\$120.00
4	8X2A	8' 2" Aluminum Crossarm/Diagonal Brace	4	\$29.00
5	DC	Diagonal Clamp	4	\$12.50
6	10P2S	10' 2" Steel Post	6	\$50.00
7	AUG2	Auger	6	\$12.25



Canopy Owner's Manual

- 18AF100**
LS1507 side tube bundle 18'
LS1508 bow bundle
LS1509 accessory box 18'
- 20AF100**
LS1514 side tube bundle 20'
LS1515 bow bundle
LS1516 accessory box 20'
- 22AF108**
LS1601 side tube bundle 22'
LS1602 bow bundle
LS1603 accessory box 22'
- 22AF120**
LS1601 side tube bundle 22'
LS1612 bow bundle
LS1603 accessory box 22'
- 24AF108**
LS1617 side tube bundle 24'
LS1614 bow bundle
LS1618 accessory box 24'
- 24AF120**
LS1617 side tube bundle 24'
LS1616 bow bundle
LS1618 accessory box 24'
- 26AF108**
LS1651 side tube bundle 26'
LS1622 bow bundle
LS1653 accessory box 26'
- 26AF120**
LS1651 side tube bundle 26'
LS1632 bow bundle
LS1653 accessory box 26'
- 28AF120**
LS1624 side tube bundle 28'
LS1625 bow bundle
LS1626 accessory box 28'

READ CAREFULLY - FAILURE TO FOLLOW INSTRUCTIONS AND SAFETY RULES MAY RESULT IN SERIOUS INJURY

WARNING. High winds will damage the Canopy. If possible remove the Canopy Cover before severe weather is in the area. Wind damage is not covered by the Lakeshore Warranty.

Manufacturers of Lakeshore Products

855 East Chicago Road, Quincy, MI 49082

www.lakeshoreproducts.com • tel: 517.639.3815 • fax: 517.639.4576

STEP 1

tools needed

7/16 wrench [for 1/4 bolts]	1
slotted screwdriver	1
tape measure	1
pencil or marker	1

1.1 assemble end caps

Take 2 Bow Tubes and slide them into the 1 Right and 1 Left Hand Corner Brackets.

[SKIP the following step for the 18' and 20' canopy]

Attach the End Middle Tube (15.5") in the center between the 2 Bow Tubes. Hold in place with:

- 2 - small galv clamps
- 2 - 1/4" x 2 1/2" carriage bolts
- 2 - 1/4" flat washer
- 2 - 1/4" hex nut

Place 1 Long Galvanized Hook between the End Middle Tube and the Small Galvanized Clamp near the top Bow Tube.

Attach the End Side Tubes (12.5") midway between the End Middle Tubes and the Corner Brackets between the Bow Tubes. Hold in place with:

- 4 - small galv clamps
- 4 - 1/4" x 2 1/2" carriage bolts
- 4 - 1/4" flat washer
- 4 - 1/4" hex nut

Place 1 Short Galvanized hook between the End Side Tube and the Clamp near the top Bow Tube.

Repeat the above procedure for the other end cap.

	18' / 20'	22' +
bow tubes	4	4
right hand corner brkts	2	2
left hand corner brkts	2	2
end side tubes 12.5"	4	4
end middle tubes 15.5"	0	2
small galv clamps	8	12
short galv hooks	4	4
long galv hooks	0	2
1/4 x 2 1/2 carriage bolt	8	12
1/4 hex nut	8	12
1/4 flat washer	8	12

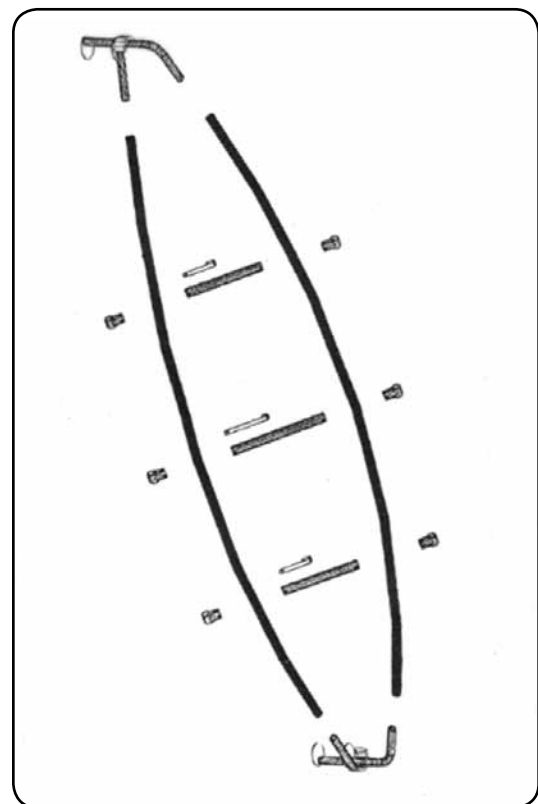

NOTE

Do not overtighten the nuts and bolts on your canopy.

The overtightening of bolts may severely damage the structural integrity of your canopy. When tightening a regular nut against an aluminum tube, tighten until the surface of the tube dimples slightly (1/8"). All lock nuts should be tightened until at least one thread of the bolt is showing through the nut. If you crush the tube, it may crack and fail under normal use.

STEP 2

2.1 assemble side tubes

Divide the supplied Side Tubes (4" diameter) into two identical pairs. For most frames this will involve a long and a short tube on each side. Lay each pair of tubes end to end and connect using :

- 1 – galvanized connector tube
- 6 - 8 – SS hose clamps

Slide a galvanized connector tube over one end of the short side tube with the stainless steel hose clamps loosely around the connector tube. Adjust the short side tube until it is approximately half way into the connector tube and tighten the stainless clamp at that end of the connector tube. Slide the long side tube into the connector until it butts up to the other tube. Tighten the remaining clamps on the connector tube making sure to align the screw mechanisms on the hose clamps.

Repeat to make a second side tube.

2.2 assemble main section

Place the side tubes parallel, with the splices directly across from each other and the stainless steel hose clamp mechanisms facing each other. Insert the corner brackets of the end cap into the side tubes. Repeat for the other end.

Mark the side tubes every 2 feet. At the first mark place

1 – large galvanized clamp

and bend it around the side tube with the long end up as shown in the exploded view. Insert one end of the bow into the loop and secure with

- 1 – 1/4" x 2 1/4" carr bolt
- 1 – 1/4" hex nut

DO NOT TIGHTEN! repeat on the other end of the bow.

Repeat until all bows and loops are assembled and positioned. Now tighten all nuts and bolts alternating from side to side. Attach the 1" nylon straps as shown in the exploded view.

	18'	20'	22'	24'	26'	28'
long side tubes	2	4	2	4	2	4
short side tubes	2	0	2	0	2	0
bow tubes	7	8	9	10	11	12
large galv clamps	14	16	18	20	22	24
galv connector tubes	2	2	2	2	2	2
SS hose clamps	6	6	6	8	8	8
1/4 x 2 1/2 carr bolt	14	16	18	20	22	24
1/4 hex nut	14	16	18	20	22	24
1/4 flat washer	14	16	18	20	22	24

- 18' has 2 - 7' and 2 - 9' side tubes
- 20' has 4 - 9' side tubes
- 22' has 2 - 9' and 2 - 11' side tubes
- 24' has 4 - 11' side tubes
- 26' has 2 - 11' and 2 - 13' side tubes

NOTE

The 24', 26' and 28' canopies have (4) SS hose clamps on each connector, where the others only require (3).

STEP 3

3.1 install canopy legs

Insert the one slotted canopy leg into the corner post of the boat lift that has the winch mounted to it. Place the remaining legs into the other three lift corner posts.

3.2 install canopy on lift

Place the assembled frame onto the cups at the top of the legs. Make certain that the canopy frame hangs further off the front of the lift than the rear. The exact amount will depend on the design of your boat, which should also be moved to the front of the lift so that the weight will be balanced. Secure the frame to the cups by using:

- 2 – SS hose clamps per cup

Be sure that the screw mechanism on the clamp is located on the inside of the frame so that the canopy can wrap around the side tube without catching.

Unfold the canopy and lay it across the frame. The inside flaps with the grommets should hang on the outside of the side tubes. Try to keep the canopy as square on the frame as possible, this will help insure a proper fit when finished.

At each grommet, take one of the bungee cords and hook one end through the grommet hole and hook the other end into the predrilled hole located on the bow. Attach the bungees in sequence alternating side to side finishing one bow before moving on to the next.

At the end caps, attach the outside corners of the canopy first by taking a bungee and hooking it through the far outside grommet, looping it over the short galvanized hook and back down to the next grommet toward the center of the canopy. Do the center bungee last in the same manner.

Adjust the legs of the canopy frame to the height desired and your canopy is installed.

	18'	20'	22'	24'	26'	28'
SS hose clamps	8	8	8	8	8	8

hints

- Your canopy will form fit a bit once it has been on the lift for a few days under the sun.
- During the off season store your canopy in a cool dry place. Wash any excess dirt off of it before storage. These steps will help prolong the life of the vinyl.
- Leave the legs in the lowest position. This will allow easier access to the top when installing the frame and the canvas.

accessory package

		18AF100	20AF100	22AF108	22AF120	24AF108	24AF120	26AF108	26AF120	28AF120
BPCANXX	bolt package canopy	1	1	1	1	1	1	1	1	1
CSXX	canopy strap	2	2	3	3	3	3	3	3	3
SSHC	stainless steel hose clamp	14	14	14	14	16	16	16	16	16
GCT	galvanized connecting tube	2	2	2	2	2	2	2	2	2
LHCB	left hand corner bracket	2	2	2	2	2	2	2	2	2
RHCB	right hand corner bracket	2	2	2	2	2	2	2	2	2
SGC	small galvanized clamp	8	8	12	12	12	12	12	12	12
LGC	large galvanized clamp	14	16	18	18	20	20	22	22	24
SGH	small galvanized hook	4	4	4	4	4	4	4	4	4
LGH	large galvanized hook	-	-	2	2	2	2	2	2	2
EMT	end middle tube	-	-	2	2	2	2	2	2	2
EST	end side tube	4	4	4	4	4	4	4	4	4
BUNT1340	bungee 3/8" x 17"	22	24	28	28	30	30	32	32	34

bolt package

		18AF100	20AF100	22AF108	22AF120	24AF108	24AF120	26AF108	26AF120	28AF120
Y250	1/4 hex bolt	22	24	30	30	32	32	34	34	36
Y252	1/4 flat washer	22	24	30	30	32	32	34	34	36
Y210C	1/4 x 2 1/2 carriage bolt	22	24	30	30	32	32	34	34	36

Ten/Two Year Limited Warranty

LSP, Inc. (Seller) warrants the aluminum structure on docks and lifts of its manufacture to be free from defects caused by material or workmanship for ten years from date of purchase. Seller will, at its option, repair or replace any such goods found on examination by Seller to be defective under normal use and service. Upon discovery of any such defect, Buyer must notify Seller in writing of defect and provide proof of purchase. Seller warrants all other materials including cast aluminum parts, mechanical components, hardware, canopy covers, cables, bunks, etc for two years. Components obtained from other manufacturers and used in Seller's products will be covered under the manufacturer's warranty and shall not be the responsibility of the Seller.

Seller's responsibility under this warranty shall be the repair or replacement of defective items. Seller is not liable for incidental or consequential damages of any kind.

Seller shall not be held responsible for repairs or modifications to its docks or lifts unless authorization has been obtained from Seller. This warranty does not cover damage caused by incorrect assembly or adjustments, overloading, improper use, neglected maintenance, alterations, or damage caused by accident, environmental factors (chemicals, tree sap, salt, etc), or acts of God (rainstorms, windstorms, tornadoes, etc).

Canopy Owner's Manual

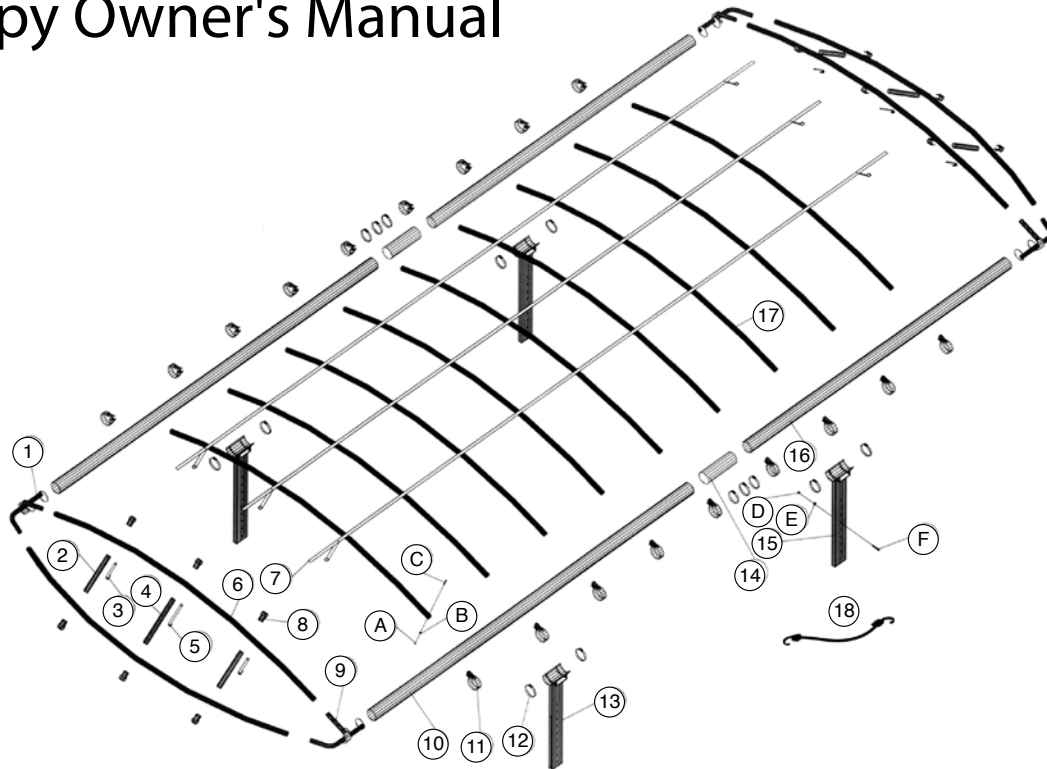

PARTS LIST

			QUANTITY PER LIFT									
			18AF100	20AF100	22AF108	22AF120	24AF108	24AF120	26AF108	26AF120	28AF120	
REF	PART NO.	PART NAME										
1	LHCB	Left Corner Bracket	2	2	2	2	2	2	2	2	2	
2	EST	End Side Tube	4	4	4	4	4	4	4	4	4	
3	SGH	Short Galvanized Hook	4	4	4	4	4	4	4	4	4	
4	EMT	End Middle Tube	-	-	2	2	2	2	2	2	2	
5	LGH	Long Galvanized Hook	-	-	2	2	2	2	2	2	2	
7	CS18	Canopy Strap 18'	2	-	-	-	-	-	-	-	-	
7	20592	Canopy Strap 20'	-	2	-	-	-	-	-	-	-	
7	CS22	Canopy Strap 22'	-	-	3	3	-	-	-	-	-	
7	CS24	Canopy Strap 24'	-	-	-	-	3	3	-	-	-	
7	CS26	Canopy Strap 26'	-	-	-	-	-	-	3	3	-	
8	SGC	Small Galvanized Clamp	8	8	12	12	12	12	12	12	12	
9	RHCB	Right Corner Bracket	2	2	2	2	2	2	2	2	2	
11	LGC	Large Galvanized Clamp	14	16	18	18	20	20	22	22	24	
12	SSHC	SS Hose Clamp	14	14	14	14	16	16	16	16	16	
13	various*	Canopy Winch Leg	-	-	-	-	-	-	-	-	-	
14	GCT	Galv Connector Tube	2	2	2	2	2	2	2	2	2	
15	various*	Canopy Leg	-	-	-	-	-	-	-	-	-	
10/16	TUBE7	Side Tube 7'	2	-	-	-	-	-	-	-	-	
10/16	TUBE9	Side Tube 9'	2	4	2	2	-	-	-	-	-	
10/16	TUBE11	Side Tube 11'	-	-	2	2	4	4	2	2	-	
10/16	TUBE13	Side Tube 13'	-	-	-	-	-	-	2	2	4	
6/17	20241	Bow Tube 108" w/ holes	-	-	13	-	14	-	15	-	-	
6/17	20242	Bow Tube 120" w/ holes	-	-	-	13	-	14	-	15	16	
6/17	20244	Bow Tube 100" w/ holes	11	12	-	-	-	-	-	-	-	
18	BUNT1340	Canopy Bungee	22	24	28	28	30	30	32	32	34	

* Canopy Leg part numbers will vary depending on Lift Model.