

# LSC1480

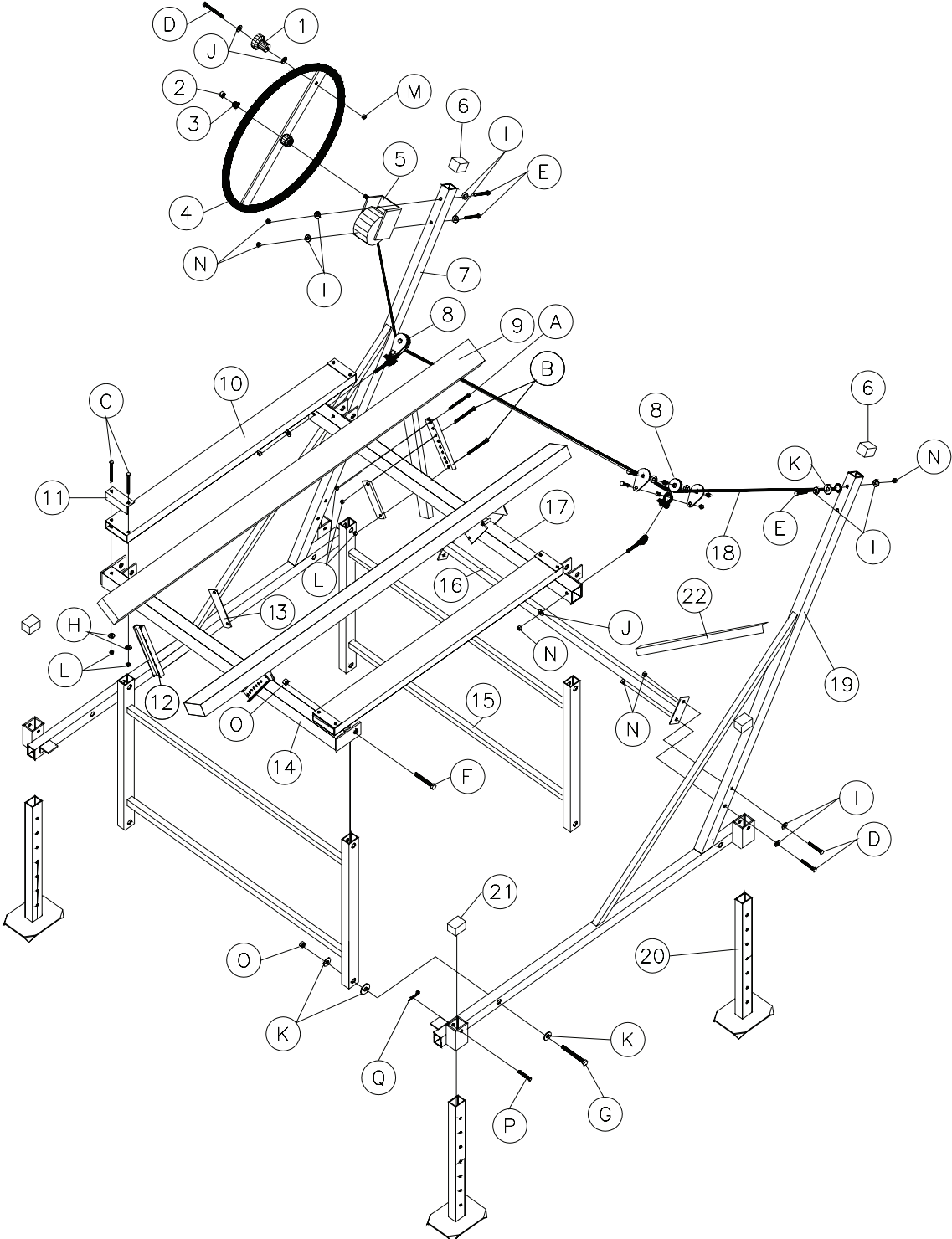

# LSC1480 PWC Lift, 1400 lbs. Load Capacity, 80" Beam Width, 35" Lift Height

## PARTS LIST

REF.	PART NO.	PART NAME	QTY.
1	20552	Wheel Knob with Fastening Hardware	1
2/3	20498	Winch Hardware Kit	1
4	LS1102	25" Wheel	1
5	JLDWINCHD	Dutton-Lainson DLB-1500 Winch	1
6	20466	1 1/2" x 4 1/2" Plastisol Cap	2
7	20439	Left Mainframe	1
8	20682	Pulley Kit	1
9	20442	Carpeted Bunk	2
10	20402	Cradle Spreader Tube	2
11	20463	Angle Cap	4
12	20501	Bunk Adjuster Channel	4
13	20502	Channel Backer Plate	4
14	20822	Rear Cradle	1
15	20820	H Unit	2
16	20819	Mainframe Spreader Tube	1
17	20821	Front Cradle	1
18	20454	Cable	1
19	20440	Right Mainframe	1
20	JLU	Leg	4
21	DEM12/CAPS1520	1 1/2" x 2" Plastisol Cap	4
22	20614	Angle Brace	2

## BOLT LIST

REF.	PART NO.	* AVAILABLE LOCALLY	PART NAME	QTY.
A	Y304	*	5/16 x 1 Hex Bolt	4
B	Y310	*	5/16 x 2 1/2 Hex Bolt	8
C	Y326	*	5/16 x 6 1/2 Hex Bolt	8
D	Y410	*	3/8 x 2 1/2 Hex Bolt	4
E	Y422	*	3/8 x 5 1/2 Hex Bolt	3
F	Y514	*	1/2 x 3 1/2 Hex Bolt	4
G	Y518	*	1/2 x 4 1/2 Hex Bolt	4
H	Y352	*	5/16 Flatwasher	16
I	Y452	*	3/8 Flatwasher	10
J	X452	*	3/8 Stainless Flatwasher	2
K	Y552	*	1/2 Flatwasher	13
L	Y353	*	5/16 Nylon Lock Nut	20
M	Y450	*	3/8 Hex Nut	1
N	Y451	*	3/8 Nylon Lock Nut	9
O	Y551	*	1/2 Nylon Lock Nut	8
P	CP		3/8 x 2 1/4 Clevis Pin	4
Q	HPC		S-Bend Cotter Pin	4
C	Y326	*	5/16 x 6 1/2 Hex Bolt	8