

LSV46108

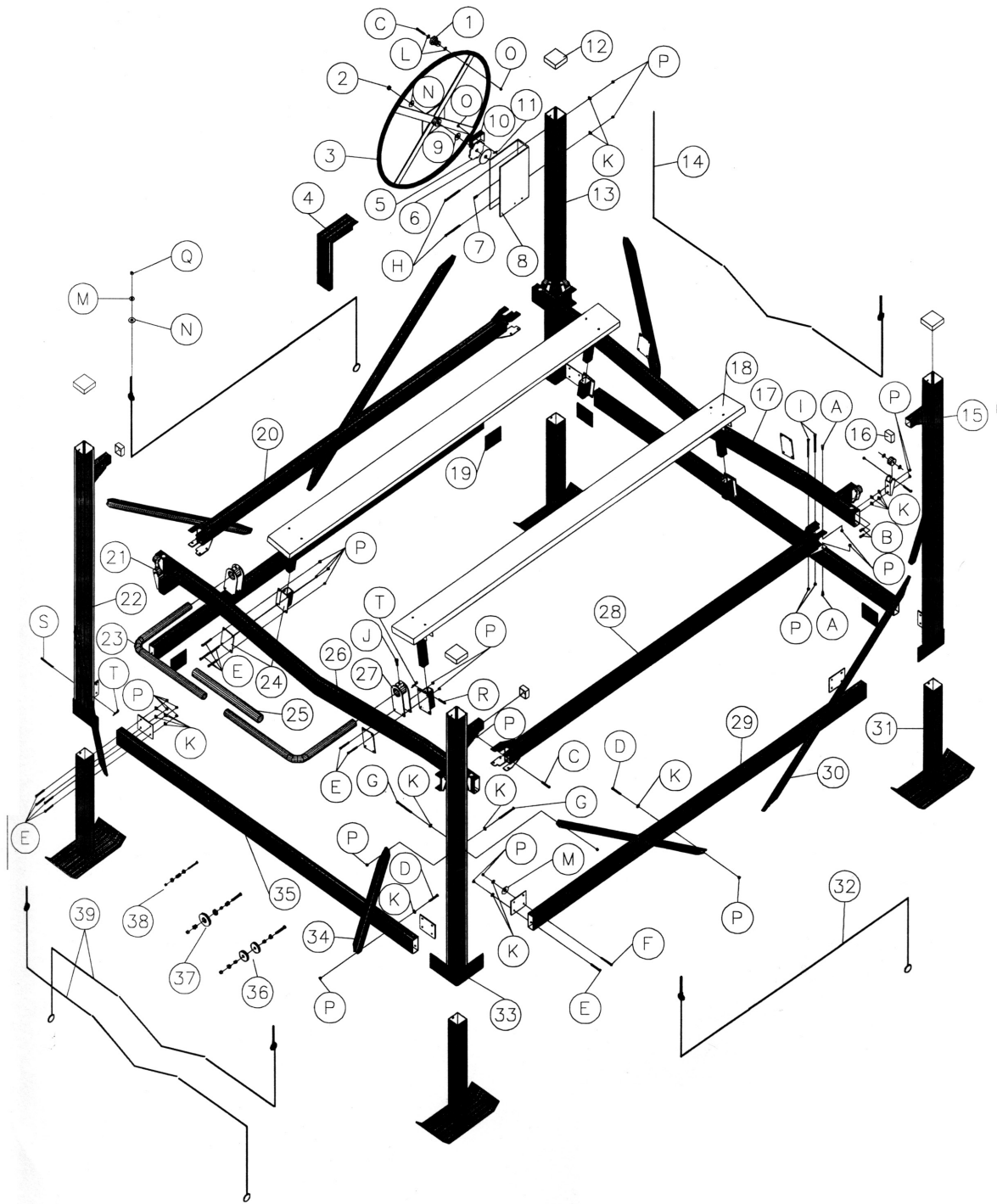

LSV46108 Vertical Lift, 4600 lbs. Load Capacity, 108" Beam Width, 64" Lift Height

PARTS LIST

REF.	PART NO.	PART NAME	QTY.
1	20552	Wheel Knob with Fastening Hardware	1
2	Y756	5/8" Jam Nut	1
3	41W	41" Wheel - no longer available*	1
4	WC1	#1 Winch Cover	1
5	WLS	Winch Locking Sprocket	1
6	WINCHBP1	Winch Brake Pad	1
7	20039	Winch Wedge	1
8	W1	Large Winch (#1) - no longer available*	1
9	W952	Bronze Thrust Washer	1
10	WSC1	Large Winch Stop Cover	1
11	20147	Large Winch Spring	1
12	DEM44	4" x 4" Plastisol Cap	4
13	VMFL1	Mainframe Post #1	1
14	20045	5/16" x 24' Front Cable Glav.	1
15	VMFL2	Mainframe Post #2	1
16	DEM22	2 1/2" x 2" Plastisol Cap	3
17	20309	Front Cradle Assembly	1
18	BUNK4000	Carpeted Wood Bunk Assembly	2
19	VFBP	Mainframe Backer Plate	8
20	VCSTA	Cradle Spreader Tube – Left	1
21	CRA	Cradle Roller Assembly	8
22	VMFL4	Mainframe Post #4	1
23	MSTUBE	Motor Stop L Tube	2
24	20119	Bunk Post Socket Assembly	4
25	MSPVC	Motor Stop PVC Tube	1
26	20309	Rear Cradle Assembly	1
27	MSB	Motor Stop Bracket	2
28	VCSTA	Cradle Spreader Tube – Right	1
29	VMFSTL	Mainframe 120" Spreader Tube	2
30	VAB2	Side Angle Brace – 71.5"	4
31	VL36	Leg	4
32	20043	1/4" x 16' 9" Side Cable	2
33	VMFL3	Mainframe Post #3	1
34	VAB1	F/R Angle Brace – 47"	4
35	VMFSTW	Mainframe 108" Spreader Tube	2
36	20148	Double Pulley Assembly	2
37	20149	Single Pulley Assembly	6
38	20150	Roller Bearing Assembly	6
39	20044	1/4" x 16' 10.5" Rear Cable	2